

INSTRUCTIONS FOR OUTDOOR MASS ON THE LAWN

AT ST. MATTHIAS PARISH

BEGINNING SUNDAY, JUNE 28 AT 10:00 AM AND TBD TIMES

RESERVATIONS REQUIRED FOR ALL CELEBRATIONS OF SUNDAY MASS

RESERVATIONS WILL BEGIN EACH THURSDAY FOR THE UPCOMING SUNDAY

Please register in either of the following ways:

Option 1: Phone Registration (508) 460-9255.

Call between 9AM and 2PM on the Thursday before the Sunday of the Mass you wish to attend.

Option 2: Online Registration. Available from Thursday 9AM to Saturday 3PM prior to the mass you wish to attend. From our website (www.stmattpar.org) or from our **Facebook** page (@stmattpar) do the following:

- ◆ Follow the [link](#) to our event in the registration system **EventBrite**.
- ◆ Click **Details** (If you would like to Follow our group to see future events, you may click the **Follow** button, otherwise this can be ignored).
- ◆ Click **Register**.
- ◆ Each person coming to Mass will need an individual reservation. Enter the number of reservations you need for one of two arrival times (9:30 or 9:45AM). Reservations are general admission (you will be shown to your spot) with staggered arrival times to allow time to check-in, park, and safely enter. Those from the same household will be seated together.
- ◆ For each reservation, (Registrant 1, Registrant 2, etc.) please indicate each individual's name, email and phone # (parents use your email and phone # for children under 18). Please answer all COVID questions for each attendee. Questions will be used for screening only and will be kept confidential.
- ◆ Registrant will receive a confirmation email with additional instructions.

Note: We advise persons in high risk categories celebrate with the parish community through online Masses.

At risk categories include persons with heart conditions, diabetes, respiratory conditions, and/or advancing age. Persons in these categories are considered to be at increased risk of more serious illness after contracting COVID-19. Your safety and the safety of your fellow parishioners is our utmost priority.

Guidelines:

- 1.) If you are sick, please do not register for a reservation to attend.
- 2.) Arrive at reserved time (9:30 or 9:45 AM for a 10:00 AM start) to allow time for check-in, parking and entrance.
- 3.) All attendees must have a reservation to attend.
- 4.) Please check our website, Facebook or call our parish office for updates, cancellations, etc.
- 5.) Please bring and wear your own mask unless there are health issues that prevent you from wearing a mask. Children under 2 are not required to wear a mask.
- 6.) Bring and use your own personal hand sanitizer.
- 7.) Observe physical distancing.
- 8.) Bring your own chair or blanket as well as water and sun covering.
- 9.) Follow the directions of all ushers, volunteers, and staff.
- 10.) You will be asked several questions at the time of registration and at the entry point regarding your exposure to COVID.

Sound provided by Baby Safe Haven. Signs donated by Gary Epstein, PracticalImage.com.

Outdoor Mass Entrance Instructions (LAWN)

Cars Enter Here:

Cars Stop and Check-in Here

Attendants will show cars to a space.

Lawn

CHURCH

Parishioners enter here to be shown to a spot on the lawn.

Walkers Enter and Check-in Here

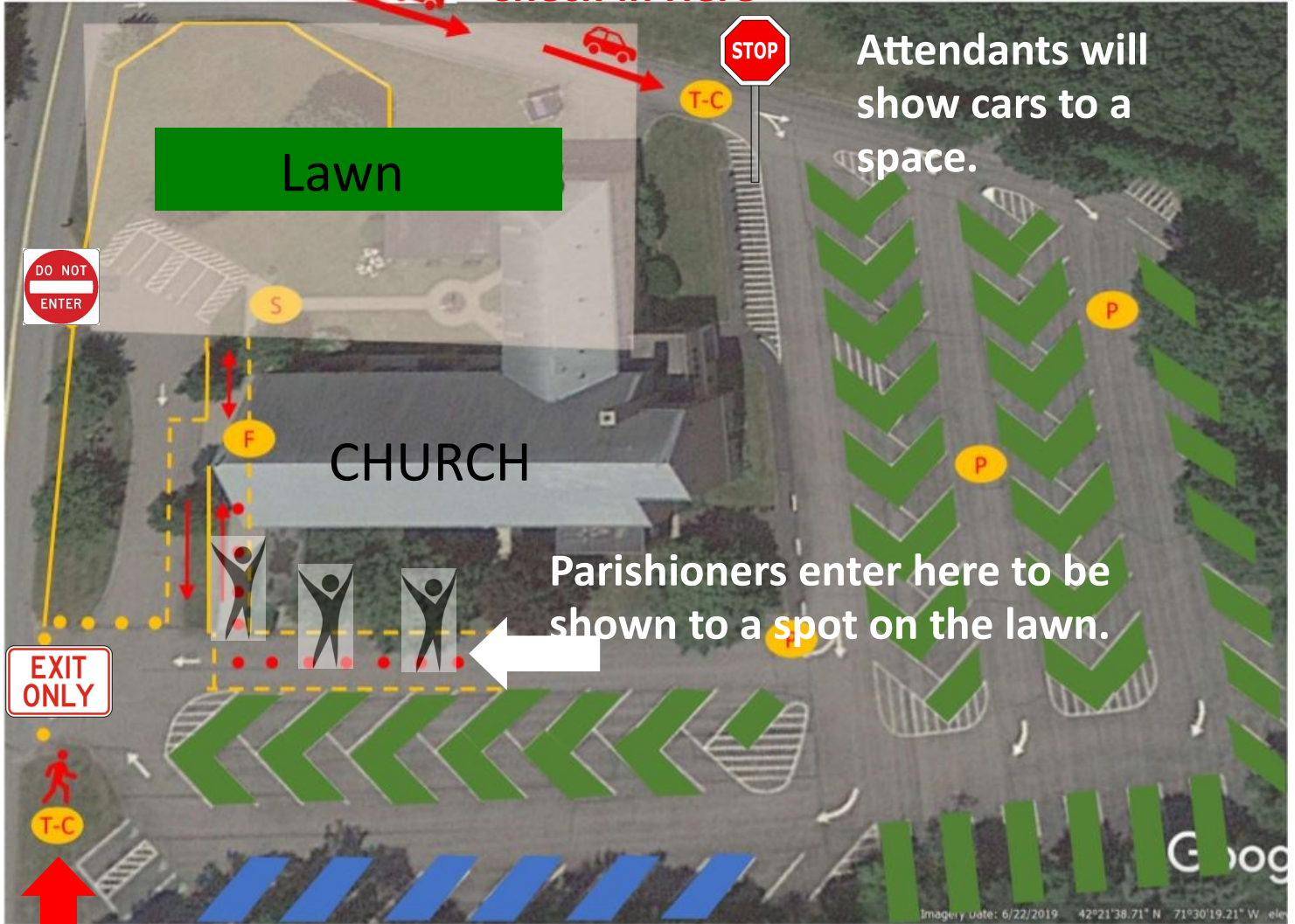

INSTRUCTIONS FOR DRIVE-IN MASS IN PARKING LOT

AT ST. MATTHIAS PARISH

SUNDAY, NOVEMBER 8 AT 10:00 AM AND TBD TIMES

RESERVATIONS REQUIRED FOR ALL CELEBRATIONS OF SUNDAY MASS

RESERVATIONS WILL BEGIN EACH THURSDAY FOR THE UPCOMING SUNDAY

Please register in either of the following ways:

Option 1: Phone Registration (508) 460-9255.

Call between 9AM and 2PM on the Thursday before the Sunday of the Mass you wish to attend.

Option 2: Online Registration. Available from Thursday 9AM to Saturday 3PM prior to the mass you wish to attend. From our website (www.stmattpar.org) or from our Facebook page (@stmattpar) do the following:

- ◆ Follow the [link](#) to our event in the registration system **EventBrite**.
- ◆ Click **Details** (If you would like to Follow our group to see future events, you may click the **Follow** button, otherwise this can be ignored).
- ◆ Click **Register**.
- ◆ Each VEHICLE/WALKER will need a Registration for a Reservation. Arrival times are staggered at 9:30 or 9:45AM to allow for safe check-in and parking. Reservations are general admission (you will be shown to your space).
- ◆ For each registration, you must answer the three COVID questions for ALL EXPECTED OCCUPANTS OF YOUR VEHICLE OR ATTENDEES IF WALKING OVER (ie. the answers must apply to all occupants as you will only be asked one time). Questions will be used for screening only and will be kept confidential. Please also enter the number of occupants/ attendees as well as list his/her full name (s) and alternate contact information if necessary.
- ◆ Registrant will receive a confirmation email with additional instructions.

Note: Your safety and the safety of your fellow parishioners is our utmost priority.

Guidelines:

- 1.) If you are sick, please do not register for a reservation to attend.
- 2.) Arrive at reserved time (9:30 or 9:45 AM for a 10:00 AM start) to allow time for check-in and parking.
- 3.) All vehicles/attendees must have a reservation to attend.
- 4.) Please check our website, Facebook or call our parish office for updates, cancellations, etc.
- 5.) Please bring and wear your own mask unless there are health issues that prevent you from wearing a mask. Children under 2 are not required to wear a mask. You must wear your mask if your windows are down and when approached for communion.
- 6.) Bring and use your own personal hand sanitizer.
- 7.) Observe physical distancing.
- 8.) Walkers: Bring your own chair or blanket as well as water and sun covering if needed. Don't forget to dress warmly as we enter the colder months.
- 9.) Follow the directions of all ushers, volunteers, and staff.
- 10.) You will be asked several questions at the time of registration and at the entry point regarding your exposure to COVID.

Sound provided by Baby Safe Haven. Signs donated by and purchased from Gary Epstein, Practicallmage.com.

Drive-in Mass Entrance Instructions (PARKING LOT)

1. Cars Enter

2. Cars Stop and Check-in Here:

3. Follow Parking Volunteers Instructions

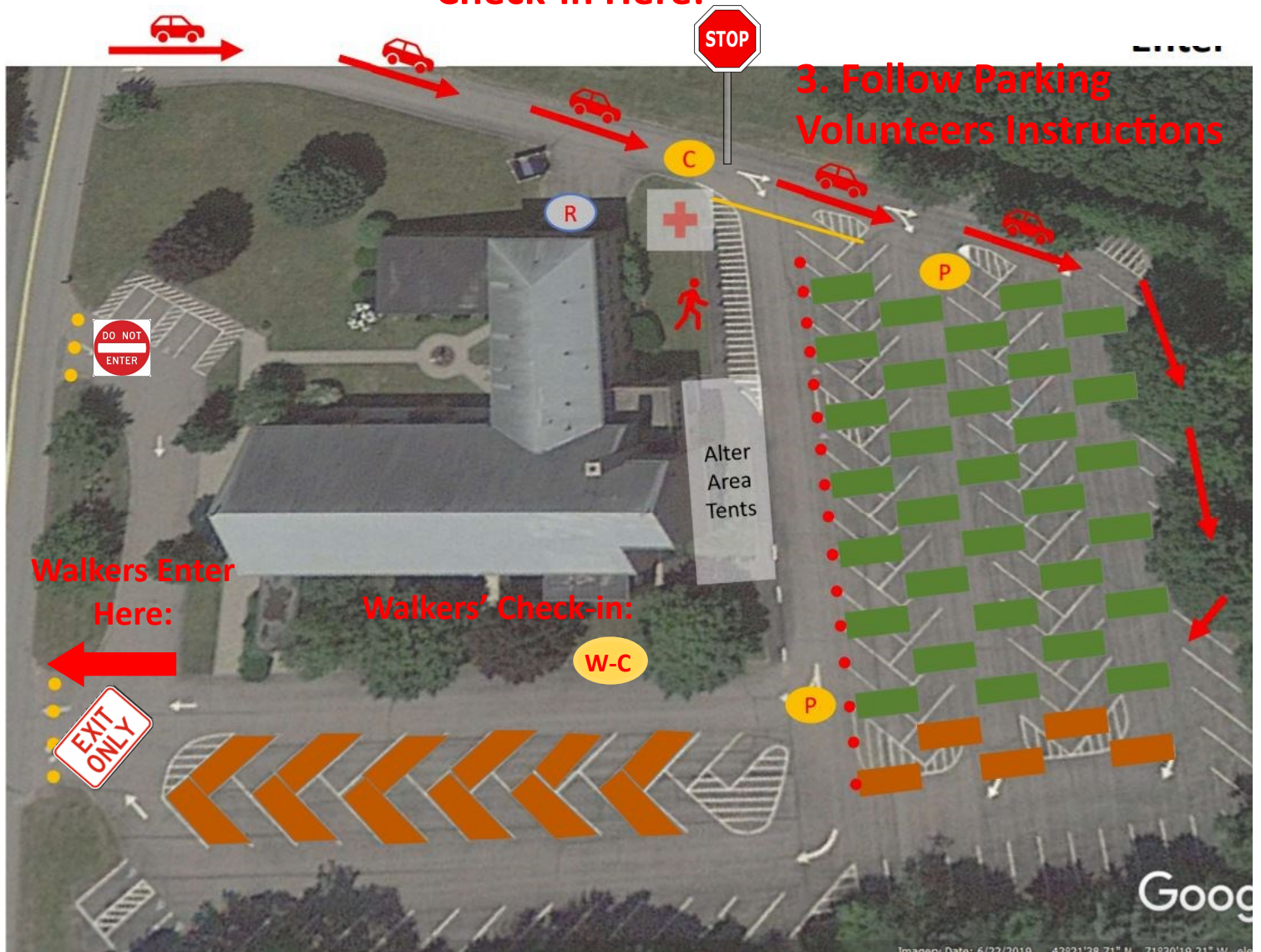

Once parked, please remain in your vehicle.

Eucharistic Ministers will approach your vehicle at Communion to offer you the host. Please have your mask on at this time.