

Concrete and Asphalt Project

On August 23rd in the presence of Alan Olsen, properties manager of the Diocese of Lansing, and with the full approval of the parish Finance Council I signed a contract with McKearney Asphalt and Sealing Company of Lansing for concrete and asphalt removal and replacement. The work will begin on September 16th with the removal and replacement of damaged sidewalk at the front of the building as well as the addition of a circular curb around the flag poll. The center of the circle around the flag pole will be made smaller and the grassy area will be removed and replaced with a wider asphalt drive around. The concrete work will be completed by August 18th.

Phase II of the project will consist of the removal and replacement of the asphalt in the circle drive and the drives extending off the circle to the south just past the two parking lots. This area will be excavated and GEO Fabric will be installed with a 8" sub-base of stone. The GEO fabric stops the gravel from sinking into the ground below and guarantees that the sub-base will hold firm for a good 20-25 years. 3 ½ " of asphalt will be installed on top of the sub-base.

The two drives going south will have a 1 ½ " overlay of asphalt. While this is not the best solution to the problem of deterioration, it is what we can afford at this point and will probably last 7 years. The two main entrance drives are in good shape and will not be in need of any repair.

The enemy of asphalt is water penetration causing the sub-base to break down. In order to assure that water does not pond in the main entrance areas the sod and soil will be removed and graded so that it will freely drain off the asphalt into the retention/drainage areas. Over the years grass and soil have been built up creating a dam thus not allowing proper drainage. This part of the project will alleviate the drainage problem. Phase II of the project will take place from September 23-27. The building will be accessible during the construction and will not interfere with Sunday Mass.

In order to fix all of our asphalt problems it would cost the parish \$400,000 to \$500,000 which is beyond what we can afford. The current project will cost \$149,000.00 with a built in contingency amount of \$15,000 to cover any unforeseen problems this will bring the total to \$164, 000.00. The project will be completely paid for with Witness to Hope contributions. As of September 30th the balance in our WTH account with the Diocese will be \$120,260.88. The Diocese will loan us up to \$45,000.00 in order to complete the project. The loan will be paid off with Witness to Hope funds as they continue to come in.

I am pleased with what we will be able to accomplish due to the generosity of those who contributed to the Witness to Hope Campaign. If there is anyway for those who have made pledges could speed up their pledge payments it would allow us to pay off the Diocesan loan in less time. Until our loan is paid off we will not be able to move forward with the cupola repair. We did so very well with the WTH Campaign. If everyone fulfills their pledges the parish will receive \$300,000-\$315,000.

I am so very grateful for your generosity and I hope that you be pleased with seeing this important project completed.

Fr. Tim

add to quote:
R&R 425 sq. ft. 4"
concrete sidewalk
Pour 100 linear
feet of curb around
flagpole

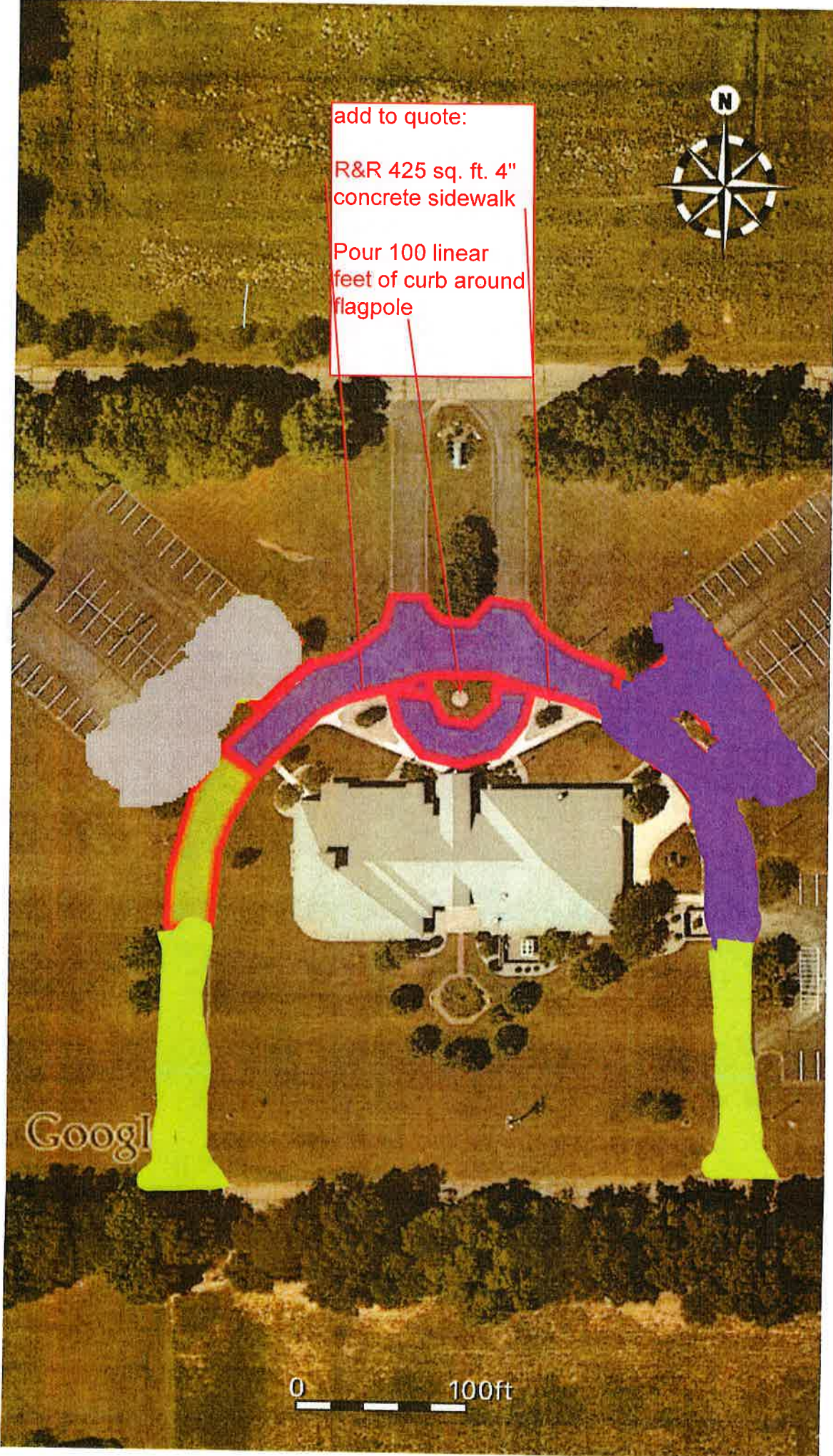

Google

0 100ft

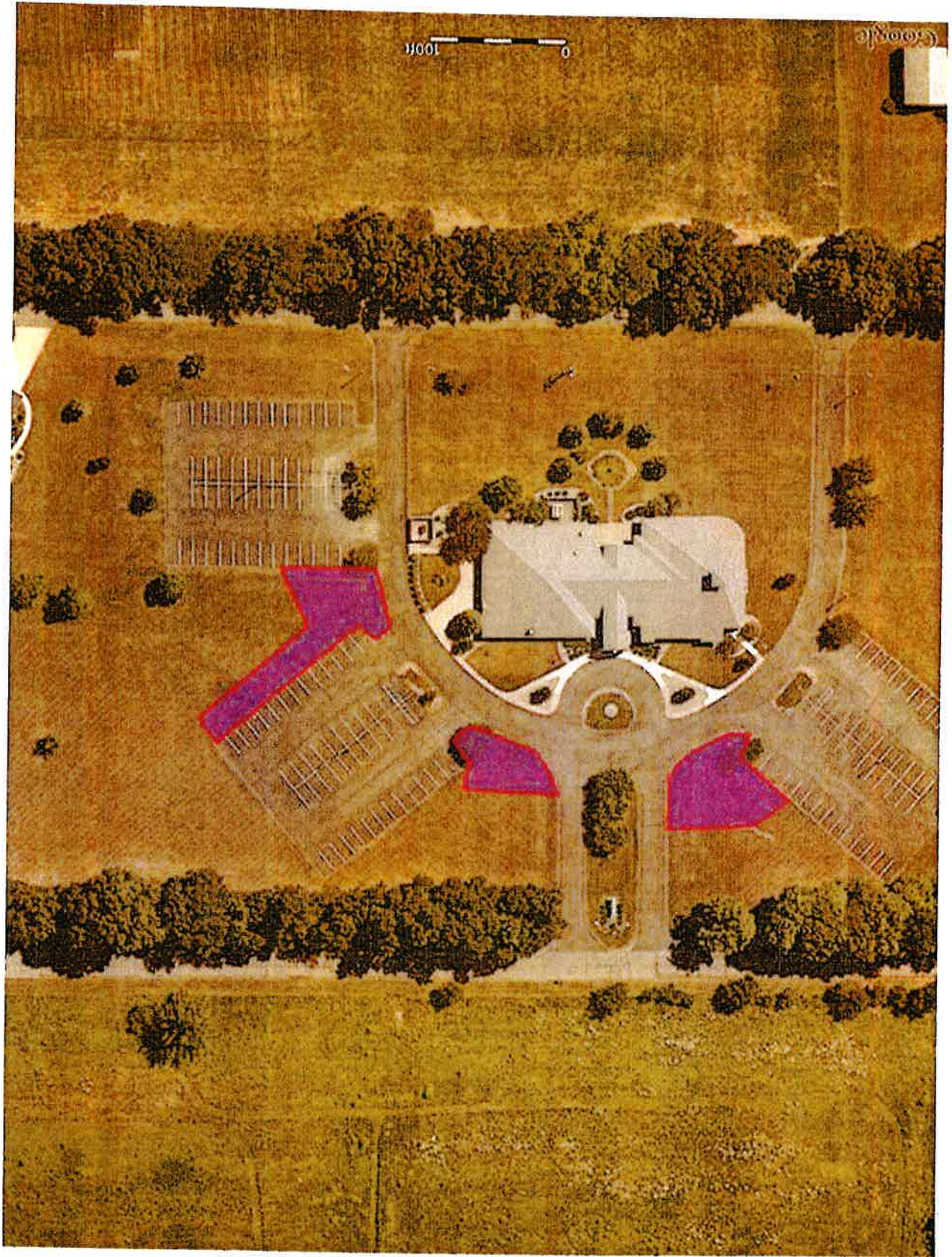

sod cut