

CHURCH - ENTRY SEATING GUIDELINES

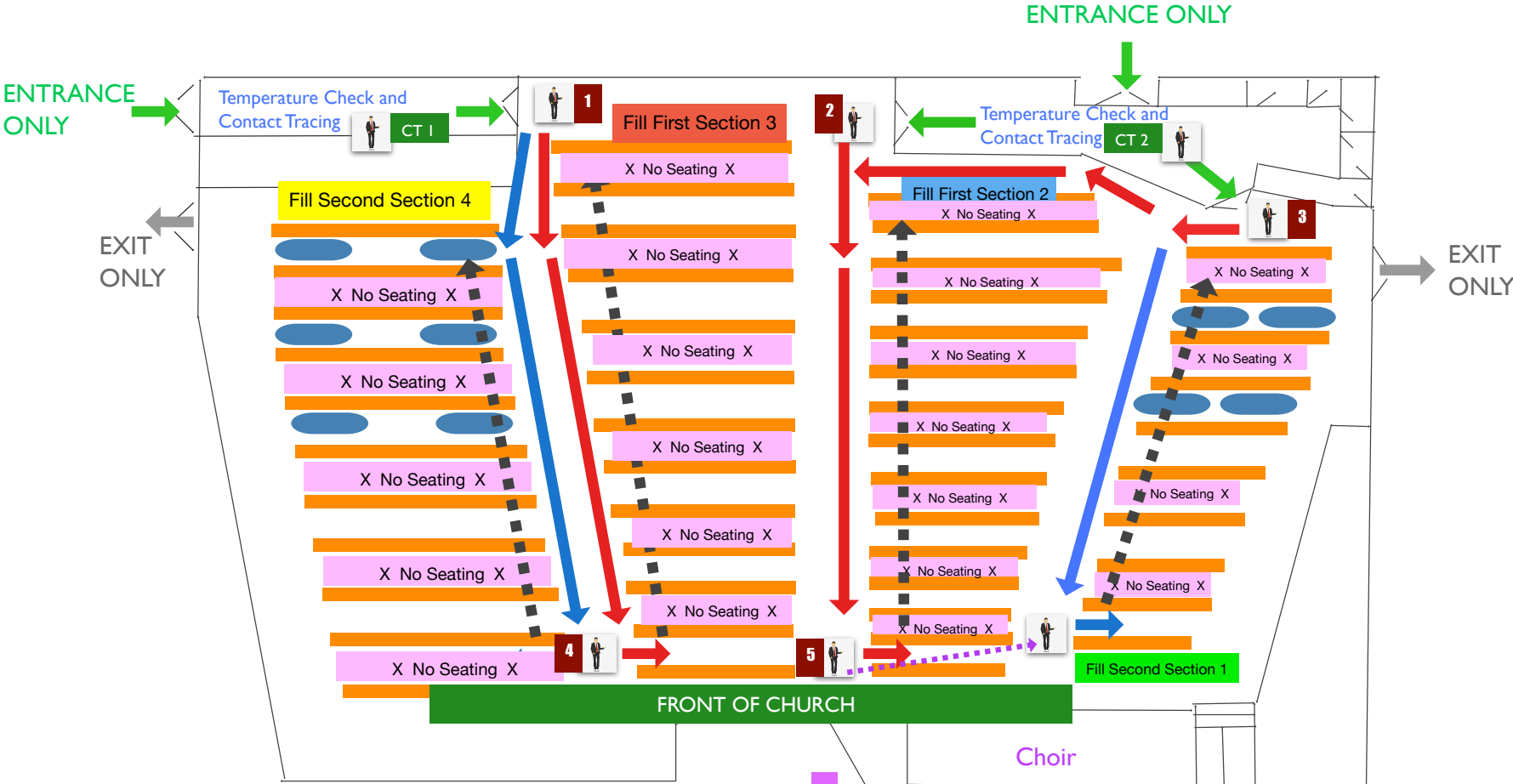

Ideally Five Hospitality Ministers Shall Help Guide Parishioners To Seat Locations. Follow These Guidelines:

- +6 Feet Distancing
- +From Front To Back
- +Designated BLUE OVAL - *Families Of SAME Household ONLY! Max 5 or up to yellow line. All Others Must Maintain 6 Feet Distancing
- +Instruct The Parishioner/s On The Proper Flow For Communion If They Are Not Familiar With Our COVID Communion Flow.
- +CT1 & CT2 shall monitor positions throughout the Mass At the end of the homily, they shall close the entry doors and prompt open the exit door.

- Legend
- Section 1 - Green
 - Section 2 - Blue
 - Section 3 - Red
 - Section 4 - Yellow
 - Green Arrows - Entrance Only
 - Grey Arrows - Exit Only
 - BLUE OVALS - Families/Groups Same Households ONLY! Max 5 or up to yellow line.
 - RED Arrows - First section seating (Sections 2 & 3)
 - BLUE Arrow - Second section seating (Sections 1 & 4)
 - Not To Scale

