

VASHON PARK DISTRICT PROPERTIES

530.08 \$ 14,190,700

Park - Property Name	Parcel #	Description	Address	Total Acres	Est. Market Value	Divestment Potential
Agren	252302-9026-03	Agren	12814 S W Bank Rd	30	\$ 500,000	Restricted - KC Interfocal Covenant
Burton Acres/Jensen Pt	126920-0240-00	Burton Acres/Jensen Point	8900 S.W. Harbor Dr	68.84	\$ 1,045,700	Restricted - KC Interfocal Covenant
CBB	182303-9195-06	No. End Community Bulletin Bd	Vashon Hwy S.W.	0.1	\$ 29,000	Vashon Senior Services Deed - 1993
Ellisport Wldlands	052203-9114-00	Upper Ellisport	Btwn Klahanie & 198th on Ridge Rd	7.8	\$ 47,000	Purchased from KC 1995
Ellisport Wldlands	052203-9011-04	Lower Ellisport	Btwn 87thS W & Ridge Rd	9.3	\$ 84,000	Purchased from KC 1995
Ridge Rd/Heyer	322303-9060-00	Deeded by K.C.	Ridge Rd S W/Heyer Natural Area	0.44	\$ 10,000	KC Deed 1999 - Offer to KC or sell
Fern Cove	132302-9002-05	House and conservation area	11408 S W Cedarhurst Rd	12.64	\$ 1,352,000	Restricted - purchased via IAC (except the house)
Fisher Pond	252302-9039-08	Shinglemill	11710 S W Bank Rd	86.8	\$ 482,000	Restricted - purchased via IAC
Fisher Pond	252302-9121-07	Shinglemill	12224 SW Bank Rd	2.69	\$ 155,000	Restricted - purchased via IAC
Fisher Pond	252302-9129-09	Shinglemill/Reifer Property	12522 SW Bank Rd	5	\$ 238,000	Restricted - purchased via IAC
Fisher Pond	252302-9131-05	Shinglemill/Ganchorro Prop	Bank Road	5	\$ 168,000	Restricted - purchased via IAC
Fisher Pond	252302-9132-04	Shinglemill/Deeded by K.C.	off Bank Road	5	\$ 117,000	Restricted - match for IAC
Fisher Pond	302303-9021-00	Property Deeded by K.C.	Cove Road/behind Fisher	9.22	\$ 194,000	Restricted - match for IAC
Fisher Pond	302303-9023-08	Property Deeded by K.C.	Cove Road/behind Fisher	9.95	\$ 73,000	Restricted - match for IAC
Fisher Pond	302303-9089-09	Shinglemill / Johnson Prop.	115th SW / behind Cove Road	10.12	\$ 226,000	Restricted - purchased via IAC
Fisher Pond	302303-9093-03	Shinglemill/Deeded by K.C.	Cove Road/behind Fisher	9.96	\$ 223,000	Restricted - match for IAC
Inspiration Pt.	252202-9070-09	Near Inspiration Pt	E of Hwy, W of Harbor Heights	2.97	\$ 118,000	Restricted - KC Interfocal Covenant
Inspiration Pt.	252202-9163-07	Inspiration Point	E of Hwy, W of Harbor Heights	0.62	\$ 53,000	Restricted - KC Interfocal Covenant
Lisabuella	112202-9037-07	Lisabuella Park	14404 S W Lisabuella Rd	4.92	\$ 367,600	Restricted - KC Interfocal Covenant
Lost Lake	362202-9001-00	Lost Lake		31.3	\$ 555,000	Purchased from KC 1995
Melita Creek Preserve	212203-9001-06	Heronry/Melita Creek	off SW 240th	2	\$ 97,000	Restricted - acquired via IAC
Melita Creek Preserve	212203-9073-09	Heronry/Melita Creek	off SW 240th	8	\$ 202,000	Restricted - acquired via IAC
Melita Creek Preserve	212203-9076-06	Heronry/Melita Creek	off SW 240th	4.88	\$ 139,000	Restricted - acquired via IAC
North End Boat Ramp						
Ober	292303-9044-06	Ober-Library & Park	17130 Vashon Hwy S W	5.47	\$ 666,300	Restricted - KC Interfocal Covenant
Paradise Ridge	122202-9063-03	Paradise Ridge Park	11716 SW 220th	43.25	\$ 483,500	Restricted - KC Interfocal Covenant
Pt. Robinson	142203-9063-00	Pt Robinson Park - Upper	3705 S W Pt. Robinson Rd	10.35	\$ 497,000	Restricted - KC Interfocal Covenant
Pt. Robinson	232203-9001-04	Pt. Robinson Park	3705 SW Pt. Robinson Rd	12	\$ 817,600	Leased via US Coast Guard
Shinglemill	192303-9011-07	Oswalt Property	11445 S W Cedarhurst Rd	20.18	\$ 260,000	Restricted - purchased via IAC
Spring Beach	352202-9023-05	Spring Beach Park		43.9	\$ 895,000	Restricted - KC Interfocal Covenant
Tramp Harbor	888600-0032-04	Tramp Harbor Land	21400 S W Water Street	0.33	\$ 5,000	Restricted - KC Interfocal Covenant
Tramp Harbor	888600-0035-01	Tramp Harbor Dock	21326 Dockton Rd S W	0.55	\$ 105,000	Restricted - KC Interfocal Covenant
Village Green	302303-9056-08	Village Green	17449 99th Ave SW	0.36	\$ 391,000	Restricted - VIGA Covenant
Whispering Firs Bog	202303-9145-03	Whispering Fir Bog	off of Vashon Hwy S.W.	1.83	\$ 23,000	Restricted - RCO funded Conservation Easement
Wingehaven	072303-9018-04	Wingehaven Park	12090 Cunliffe Rd S W	17.2	\$ 399,000	Restricted - KC Interfocal Covenant
Wingehaven	072303-9167-03	Portion of Wingehaven prop.	Cunliffe Rd. SW	0.56	\$ 21,000	Restricted - KC Interfocal Covenant
VES				15	\$ 2,500,000	Leased via VISD - restricted via RCO
BARC				10		Leased via VISD - restricted via KCYSF
Vashon Pool						Leased via VISD
General	072203-9117-05	Property Deeded by K.C.	Corner of 216th & 103rd	0.26	\$ 61,000	KC Deed 1999 - Offer to KC or sell
General	082203-9097-08	Tacoma Yacht Club prop.	Quartermaster Harbor / Portage	0.37	\$ 340,000	KC Deed 1999 - Offer to KC or sell

General	182203-9054-07	Property Deeded by K.C.	Burton Peninsula - beach? Water?	5.75 \$	10,000	KC Deed 1999 - Offer to KC or sell
General	292303-9065-00	Hitchings Prop	SW Soper Road	0.16 \$	23,000	Offer to KC
General	292303-9259-06	Hitchings Prop	SW Soper Road	0.11 \$	23,000	Offer to KC
General	312203-9014-09	Porton of Rosehilla Bch	Manzanita / 101st Ave S W	0.45 \$	1,000	KC Deed 1999 - Offer to KC or sell
General	855000-0111-03	Tacoma Yacht Club prop.	Manzanita	0.12 \$	500	KC Deed 1999 - Offer to KC or sell
General	855000-0115-09	Tacoma Yacht Club prop.	Manzanita	2.18 \$	34,000	KC Deed 1999 - Offer to KC or sell
General	855000-0376-03	Tacoma Yacht Club prop.	Manzanita	0.02 \$	500	KC Deed 1999 - Offer to KC or sell
General	855000-0651-09	Tacoma Yacht Club prop.	Manzanita	0.81 \$	1,000	KC Deed 1999 - Offer to KC or sell
General	855000-0920-04	Tacoma Yacht Club prop.	Manzanita	2.69 \$	25,000	KC Deed 1999 - Offer to KC or sell
General	855000-1290-04	Tacoma Yacht Club prop.	Manzanita	0.85 \$	10,000	KC Deed 1999 - Offer to KC or sell
General	855000-1655-03	Tacoma Yacht Club prop.	Manzanita	0.97 \$	10,000	KC Deed 1999 - Offer to KC or sell
General	855000-1850-06	Tacoma Yacht Club prop.	Manzanita	0.95 \$	10,000	KC Deed 1999 - Offer to KC or sell
General	855000-1995-02	Tacoma Yacht Club prop.	Manzanita	1.69 \$	24,000	KC Deed 1999 - Offer to KC or sell
General	855000-2110-00	Tacoma Yacht Club prop.	Manzanita	2.38 \$	54,000	KC Deed 1999 - Offer to KC or sell
General	855000-2500-08	Tacoma Yacht Club prop.	Manzanita	1.69 \$	24,000	KC Deed 1999 - Offer to KC or sell
General	855000-2585-06	Tacoma Yacht Club prop.	Manzanita	0.1 \$	1,000	KC Deed 1999 - Offer to KC or sell

King County Interfocal Covenant - must operate and maintain in perpetuity as a public open space or as public parks recreational facility, except that the District may trade the facility for property of equal or greater parks and recreational value or open space value. Covenant shall continue in force unless both parties mutually consent in writing to its termination.

Spring Beach - potential KC interest in taking this back in partnership with the Land Trust for trail system.

Fisher Pond/Shindlen Hill - IAC (Interagency Committee for Outdoor Recreation) was the state grant agency that facilitated a land match arrangement between the Land Trust and VPD for Bill Fisher's donation of property to the Land Trust for a Conservation Easement. The grant allowed us to purchase properties for the easement, and the match component could be other land that would also fall under the easement.

Belle Baldwin House - State and King County Historic Landmark. Past grants include KC Cultural Facilities, KC Special Projects, and 4Culture. Can not find grant contracts, so unaware of covenants prohibiting sale of the house only (land protected by grant covenant). If we can sell the house, expect push back from the community.

Milista Creek Preserve - acquired in concert with the Land Trust and Audobon Society via IAC for preservation of the blue heron nesting rookery.

VIGA Covenant - Vashon Island Grower's Association purchased the land in 1999 and conveyed it to VPD with the stipulation that it be preserved as green space for the use of the community and to maintain a local farmer's market as long as there are individual or collective local growers willing to sell products at this location.

Ellisport Wetlands - committed to the Land Trust to preserve as habitat conservation under Land Trust's stewardship. 1999 \$5,000 Water Works grant for clean-up - no covenants.

Lost Lake - Stewarded by the Land Trust. Potential KC interest in acquiring this for trail system.

KC Deed 1999 - King County no longer wanted these properties that were foreclosures for delinquent property taxes. Sold to VPD for no more than the back taxes owed -- \$6263.

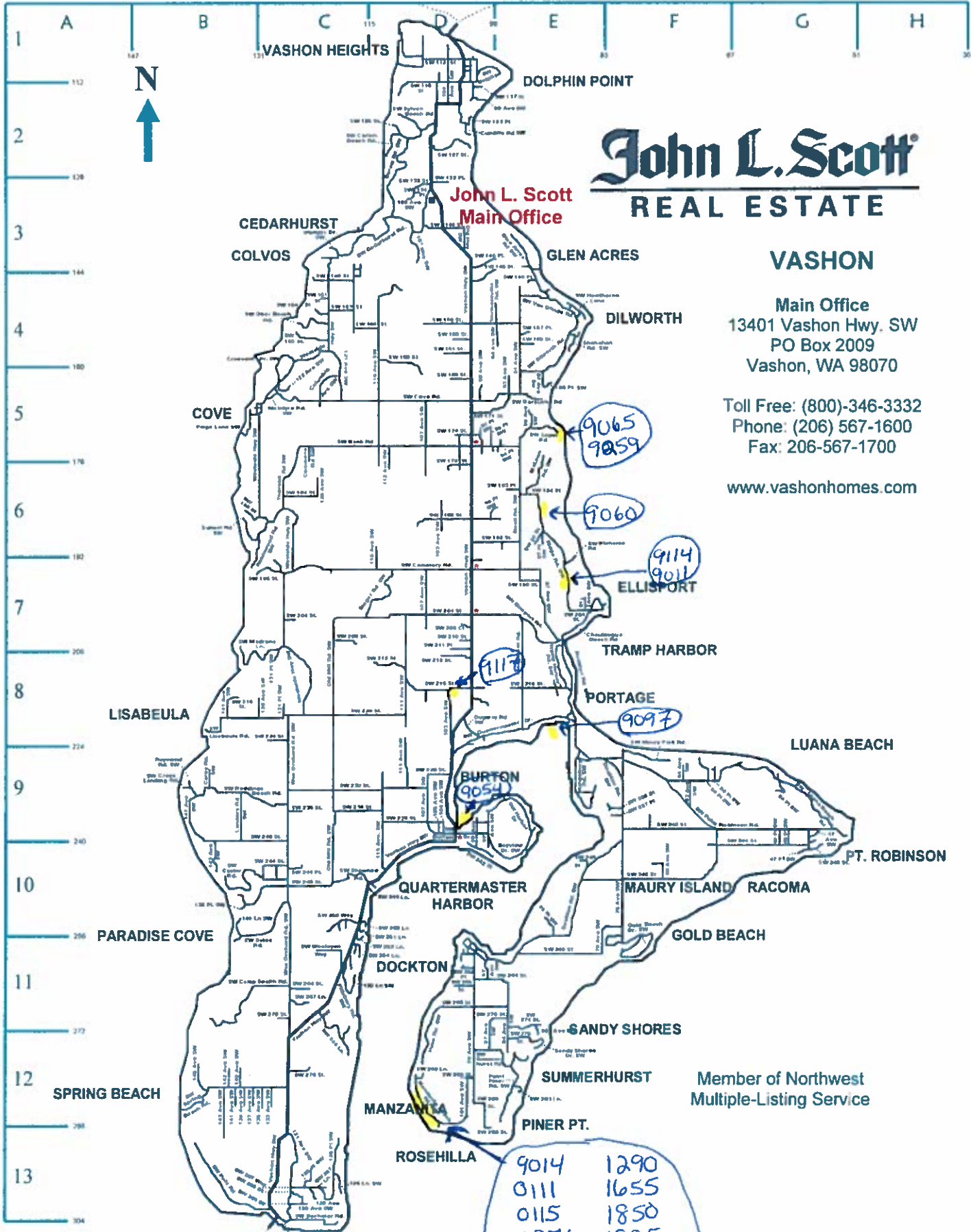

John L. Scott

REAL ESTATE

**John L. Scott
Main Office**

VASHON

Main Office
13401 Vashon Hwy. SW
PO Box 2009
Vashon, WA 98070

Toll Free: (800)-346-3332
Phone: (206) 567-1600
Fax: 206-567-1700

www.vashonhomes.com

9065
9059

9060

9114
9011

7117

9097

BURTON
9054

9014 1290
0111 1655
0115 1850
0376 1995
0651 2110
0920 2500
2585

Member of Northwest
Multiple-Listing Service

Ellisport 0522039114_0522039011 5223039060

King County

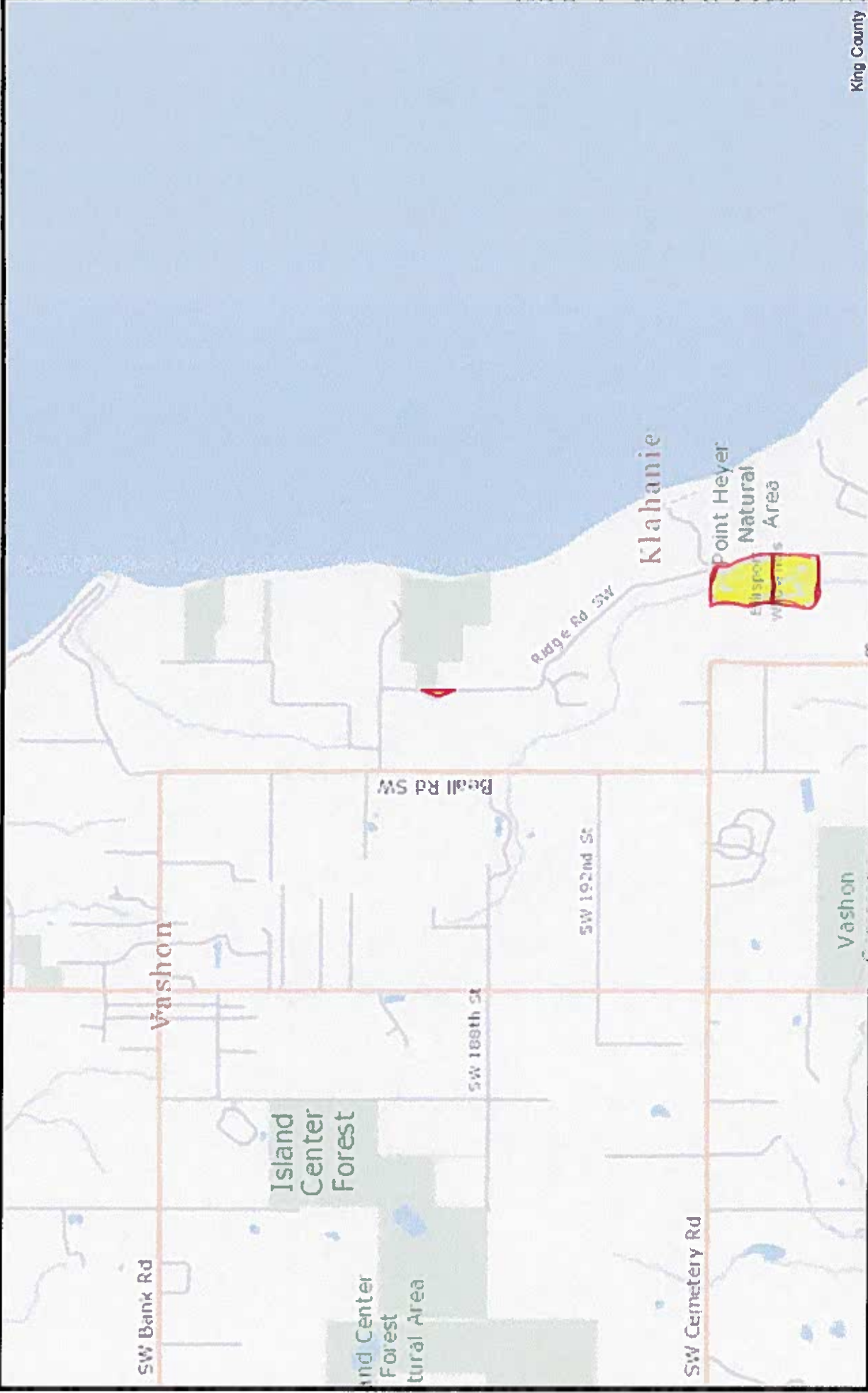

King County

The information included on this map has been compiled by King County staff from a variety of sources and is subject to change without notice. King County makes no representations or warranties, express or implied, as to accuracy, completeness, timeliness, or rights to the use of such information. This document is not intended for use as a survey product. King County shall not be liable for any general, special, incidental, or consequential damages including, but not limited to, lost revenues or lost profits resulting from the use or misuse of the information contained on this map. Any sale of this map or information on this map is prohibited except by written permission of King County.

Date: 11/12/2014

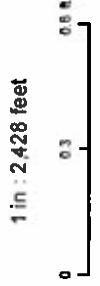

0722039117

King County

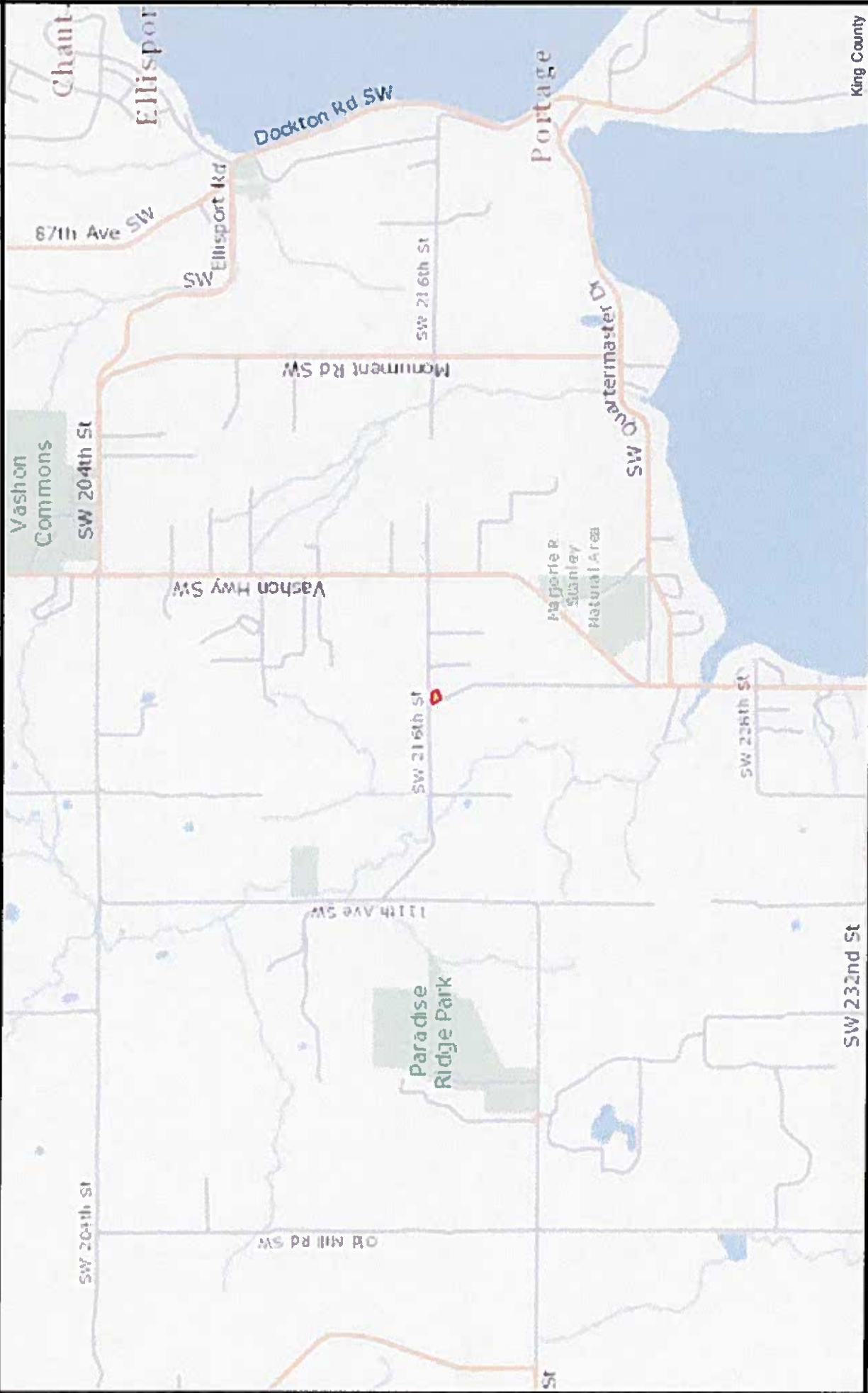

The information included on this map has been compiled by King County staff from a variety of sources and is subject to change without notice. King County makes no representations or warranties, express or implied, as to accuracy, completeness, timeliness, or rights to the use of such information. This document is not intended for use as a survey product. King County shall not be liable for any general, special, indirect, incidental, or consequential damages including, but not limited to, lost revenues or bad profits resulting from the use or misuse of the information contained on this map. Any sale of this map or information on this map is prohibited except by written permission of King County.

Date: 11/12/2014

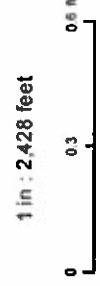

1 in : 2,426 feet



King County

0822039097

King County

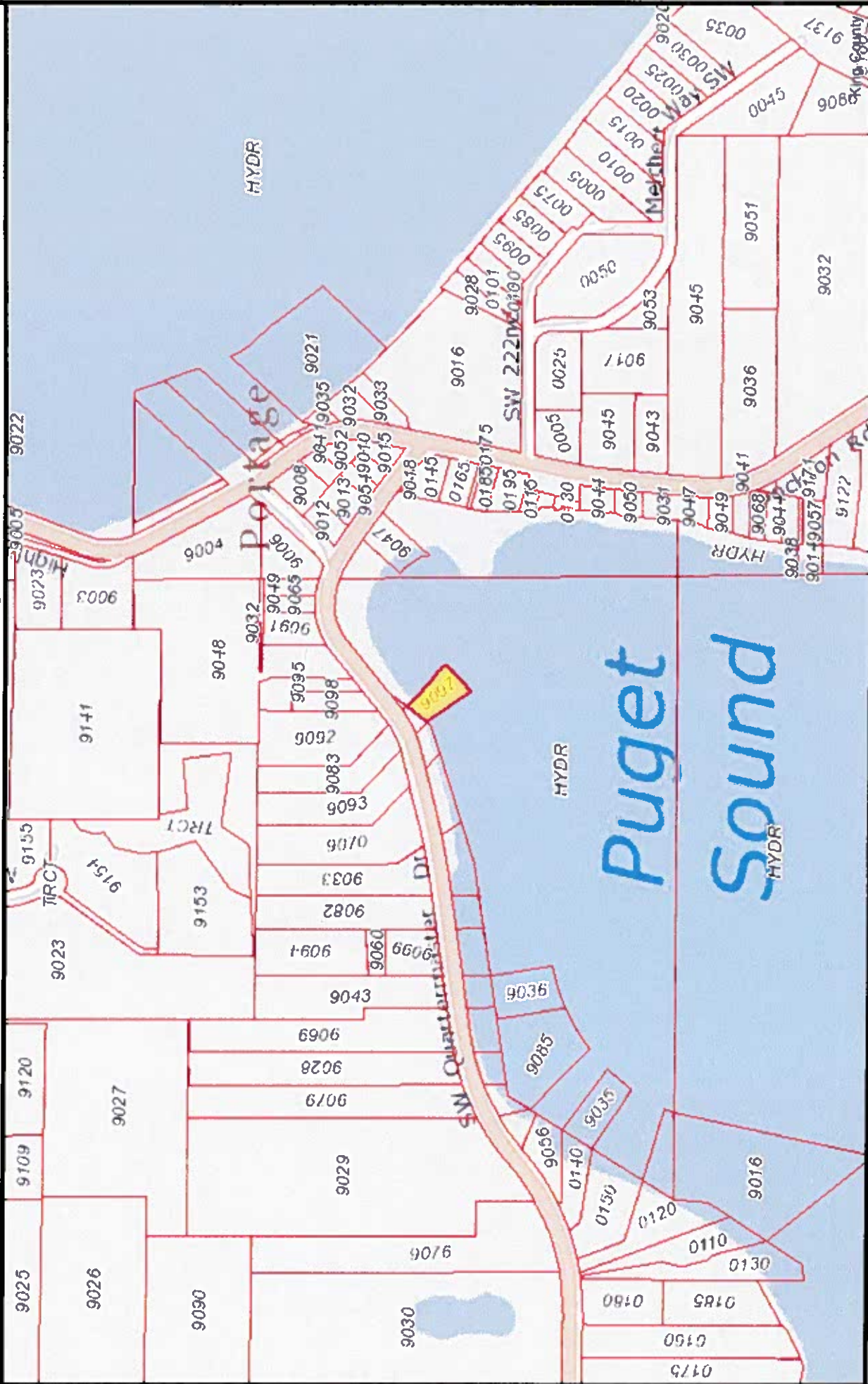

The information included on this map has been compiled by King County staff from a variety of sources and is subject to change without notice. King County makes no representations or warranties, express or implied, as to accuracy, completeness, timeliness or rights to the use of such information. This document is not intended for use as a survey product. King County shall not be liable for any general, special, indirect, incidental, or consequential damages including, but not limited to, lost revenues or lost profits resulting from the use or misuse of the information contained on this map. Any sale of this map or information on this map is prohibited except by written permission of King County.

Date: 11/12/2014

1 in : 607 feet



1822039054

King County



The information included on this map has been compiled by King County staff from a variety of sources and is subject to change without notice. King County makes no representations or warranties, express or implied, as to accuracy, completeness, timeliness, or rights to the use of such information. This document is not intended for use as a survey product. King County shall not be liable for any general, special, indirect, incidental, or consequential damages including, but not limited to, lost revenues or lost profits resulting from the use or misuse of the information contained on this map. Any sale of this map or information on this map is prohibited except by written permission of King County.

Date: 11/12/2014

1 in : 1214 feet

0 0.15 0.3 R

N

King County
GIS CENTER

11.7.2014 2923039065 & 2923039259

King County

King County

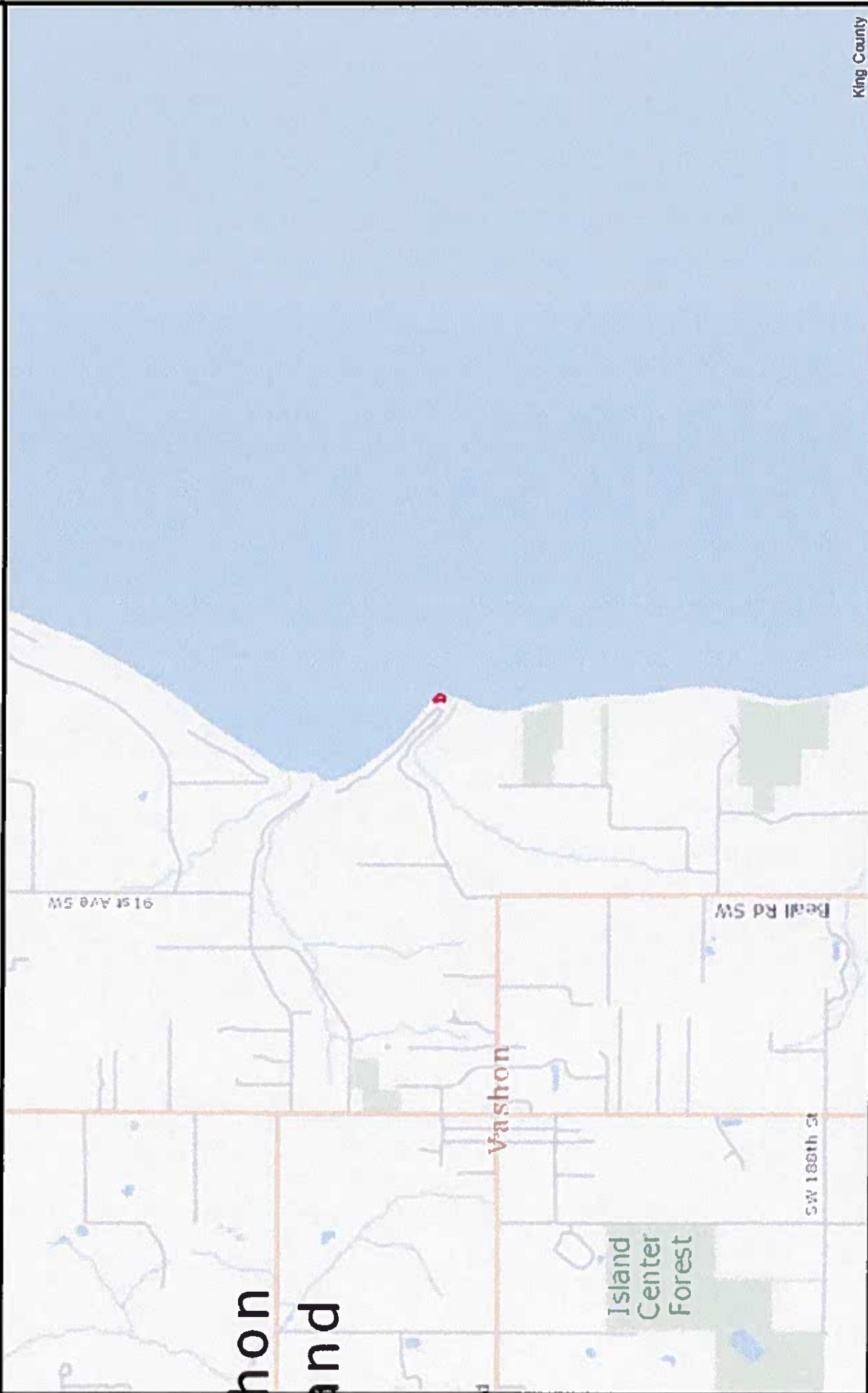

1 in : 2,428 feet



The information included on this map has been compiled by King County staff from a variety of sources and is subject to change without notice. King County makes no representations or warranties, express or implied, as to accuracy, completeness, timeliness, or rights to the use of such information. This document is not intended for use as a survey product. King County shall not be liable for any general, special, indirect, incidental, or consequential damages including, but not limited to, lost revenues or lost profits resulting from the use or misuse of the information contained on this map. Any sale of this map or information on this map is prohibited except by written permission of King County.

Date: 11/12/2014



King County

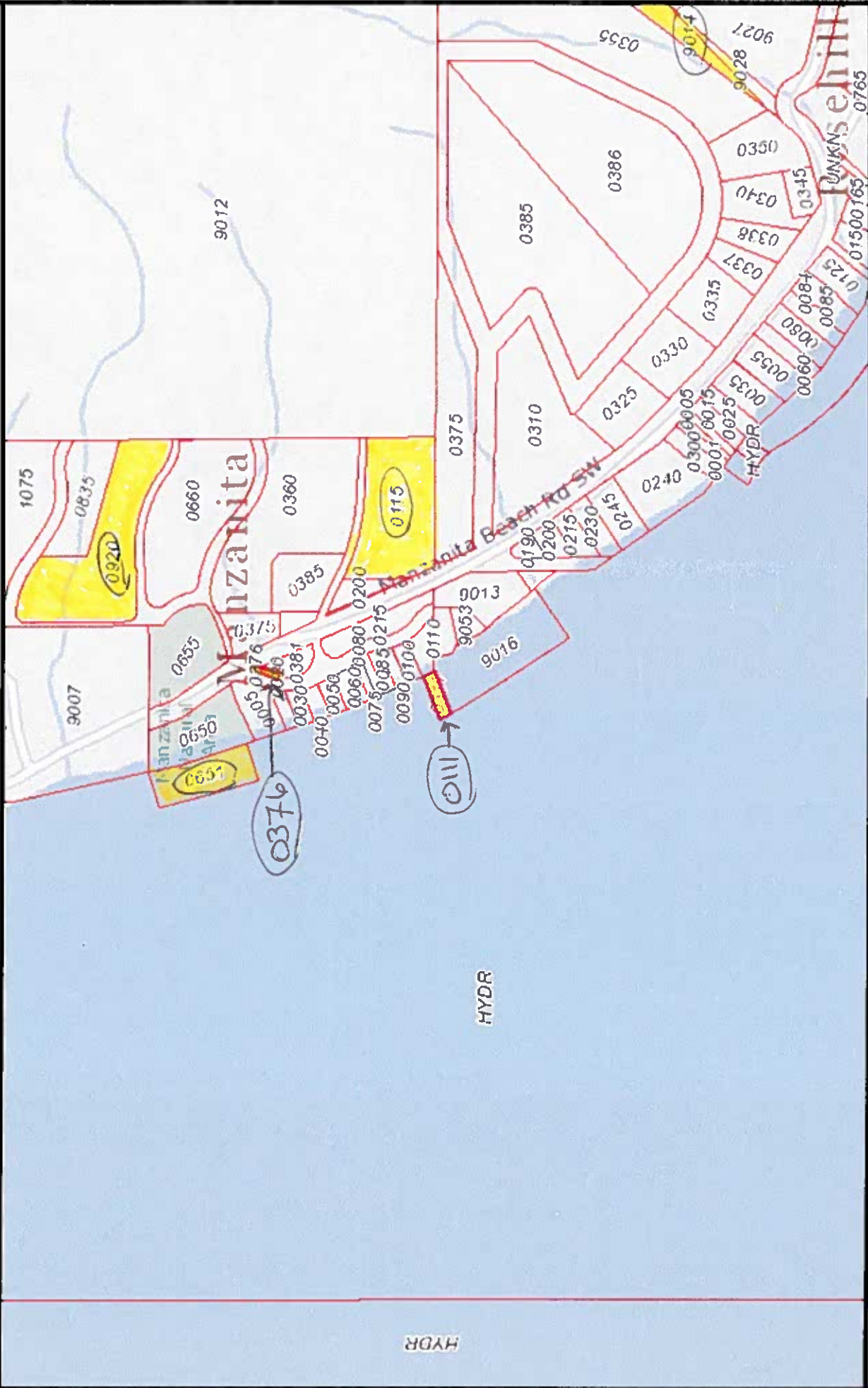

The information included on this map has been compiled by King County staff from a variety of sources and is subject to change without notice. King County makes no representations or warranties, express or implied, as to accuracy, completeness, timeliness or rights to the use of such information. This document is not intended for use as a survey product. King County shall not be liable for any general, special, indirect, incidental, or consequential damages including, but not limited to, lost revenues or lost profits resulting from the use or misuse of the information contained on this map. Any sale of this map or information on this map is prohibited except by written permission of King County.

Date: 11/12/2014

1 in : 607 feet
 0 0.075 0.15 ft



King County

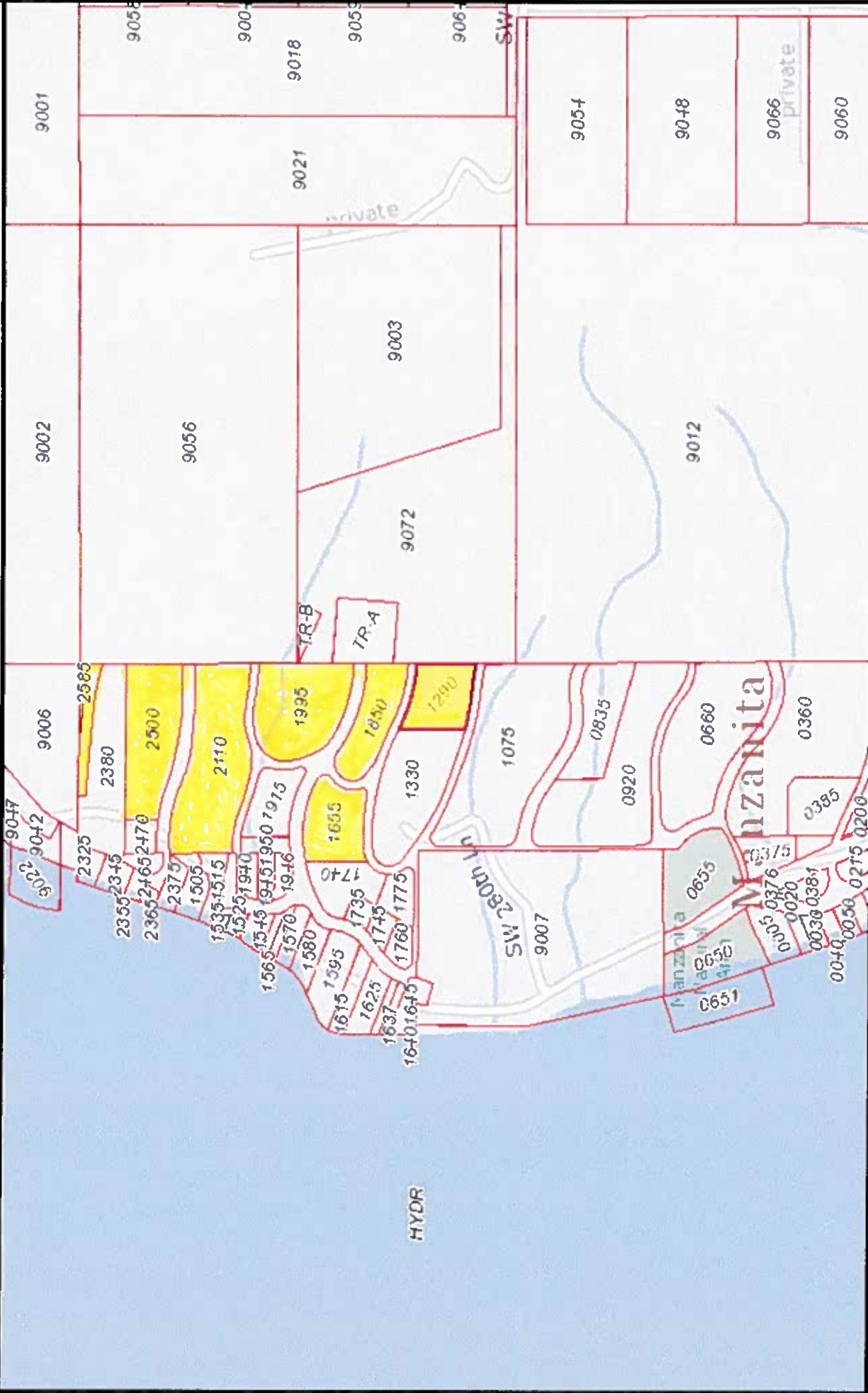

The information included on this map has been compiled by King County staff from a variety of sources and is subject to change without notice. King County makes no representations or warranties, express or implied, as to accuracy, completeness, timeliness, or rights to the use of such information. This document is not intended for use as a survey product. King County shall not be liable for any general, special, indirect, incidental, or consequential damages including, but not limited to, lost revenues or lost profits resulting from the use or misuse of the information contained on this map. Any sale of this map or information on this map is prohibited except by written permission of King County.

Date: 11/13/2014

